

PRESENTATION AND FIXTURE PLAN

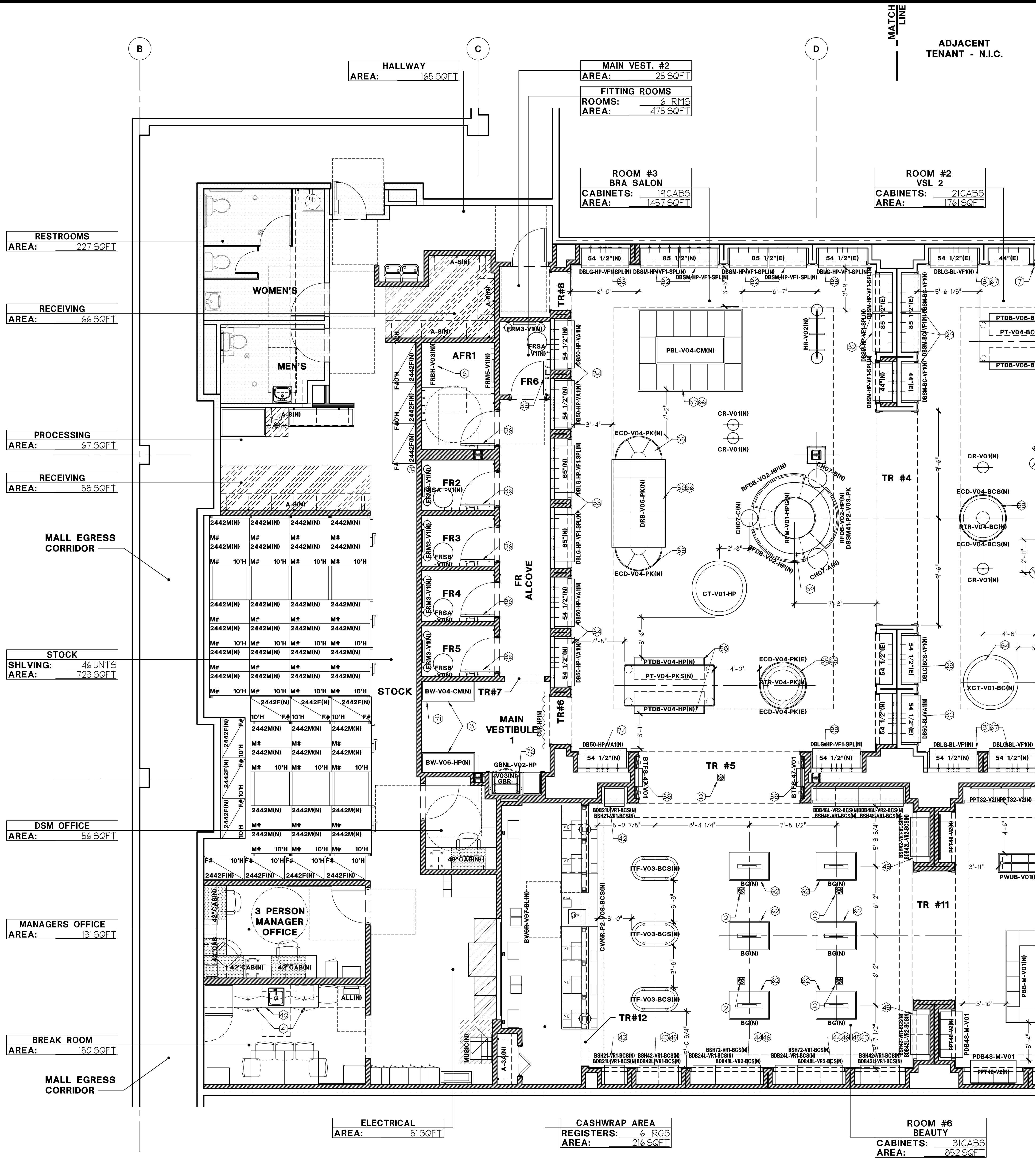

- ① (E) ALUMINUM AND GLASS STOREFRONT - REFER TO A06.X
- ② (N) FLOOR OUTLET, SEE ELECTRICAL DRAWINGS FOR SPECIFICATIONS
- ③ (N) BRA WARDROBE FIXTURE, REFER TO DETAIL L/A11.2 FOR ATTACHMENT.
- ④ (N) PINK ARMOIRE FIXTURE, REFER TO DETAIL E/A10.7 FOR ATTACHMENT AND LADDER RAIL DETAILS.
- ⑤ (N) BRASS HOOK, ATTACH WITH VENDOR SUPPLIED SCREWS. IF BLOCKING AND/OR WOOD TRIM IS NOT PRESENT USE HILTI HPF GYP BD ANCHORS. REFER TO INTERIOR ELEVATIONS FOR HEIGHT.
- ⑥ VSL ACCESSIBLE FITTING ROOM BENCH - REFER TO J/A11.7
- ⑦ CRYSTAL KNOB INSTALL ON PILASTER OR COLUMN FACE @5'-3" A.F.F. G.C. TO INSTALL W/ VENDOR PROVIDED TOGGLE BOLTS.
- ⑧ (N) LIGHTBOX TOWER FIXTURE, REFER TO STOREFRONT ELEVATION FOR GRAPHIC TAG CALLOUT.
- ⑨ (N) SUPPORTED DRAPERY MOUNTED TO FACE OF BALANCE ABOVE TRANSITION, REFER TO DETAIL L/A11.05
- ⑩ (N) CRYSTAL KNOB INSTALL ON COLUMN FACE @ 5'-3" A.F.F. G.C. TO INSTALL W/ VENDOR PROVIDED TOGGLE BOLTS.
- ⑪ G.C. TO TOUCH UP FIXTURE AS NECESSARY TO PUT INTO "LIKE-NEW" CONDITION, REFER TO PLAN FOR COLOR
- ⑫ (N) CURTAIN AND CEILING MOUNTED TRACK.

INVENTORY NOTES:

- | | |
|--|---|
| ⑫ (6) INV #66937-ROYAL LASER | ⑤② (2) INV #61032-LT |
| ⑫ (1) INV #65955-LT | ⑤③ (3) INV #64836-LT |
| ⑫ (3) INV #66916-ROYAL LASER | ⑤④ (3) INV #72166-LT |
| ⑫ (4) INV #67340-ROYAL LASER | ⑤⑤ (1) INV #61014-LT |
| ⑫ (1) INV #67372-ROYAL LASER | ⑤⑥ (4) INV #64837-LT |
| ⑫ (2) INV #67363-ROYAL LASER | ⑤⑦ (1) INV #61014-LT |
| ⑫ (2) INV #67204-LT | ⑤⑧ (1) INV #61173-LT |
| ⑫ (4) INV #67232-LT | ⑤⑨ (2) INV #61033-LT |
| ⑫ (3) INV #67340-ROYAL LASER | ⑤⑩ (1) INV #76093 HIGH COUNTRY |
| ⑫ (6) INV #66937-ROYAL LASER | ⑤⑪ (N) CARPET INV #66936 ATLAS |
| ⑫ (1) INV #67229-LT | ⑤⑫ (1) INV #68484-ARRAY |
| ⑫ (6) INV #67337-ROYAL LASER | ⑤⑬ (6) INV #74572-RL |
| ⑫ (7) INV #66937-ROYAL LASER, REPAINT HOT PINK (P-45) | ⑤⑭ NOT USED |
| ⑫ (5) INV #67337-ROYAL LASER, REPAINT HOT PINK (P-45) | ⑤⑮ (2) INV #71676-RL |
| ⑫ (1) INV #65961-LT | ⑤⑯ (N) PREFINISHED MEDIUM PINK CUP PULL, INV #68260-LT ON ALL HOT PINK FIXTURES |
| ⑫ (5) INV #65962-LT | ⑤⑰ (N) PREFINISHED TOUCH OF PINK CUP PULL, INV #68124 ON ALL TOUCH OF PINK FIXTURES |
| ⑫ NOT USED | ⑤⑱ (N) PREFINISHED BLACK CUP PULLS, INV #68021-LT ON ALL BLACK FIXTURES |
| ⑫ (2) INV #76527 ARRAY | ⑤⑲ PROVIDE (24) SHELVES SH-PK-V01, INV #61061 |
| ⑫ (2) INV #74399 HIGH COUNTRY | ⑤⑳ PROVIDE (24) SHELVES SH-SM-VFI-PK, INV #61080 |
| ⑫ (1) INV #5835367-LT SINK SKIRT | ⑥① (2) INV# 72707 HIGH COUNTRY |
| ⑫ (1) INV #58532-LT BASE CABINET | ⑥② (1) INV # 67296-LT |
| ⑫ (2) INV #74398 HIGH COUNTRY | ⑥③ (2) INV # 61174-LT |
| ⑫ (2) INV#74400 HIGH COUNTRY | ⑥④ (N) PREFINISHED BLACK CHERRY CUP PULLS ON ALL BLACK CHERRY DRAWER BARS |
| ⑫ (2) INV #74399 HIGH COUNTRY | ⑥⑤ (3) INV #74150-LT |
| ⑫ (16) INV #72710 HIGH COUNTRY | ⑥⑥ (6) INV #63632-LT |
| ⑫ (8) INV #72711 HIGH COUNTRY | ⑥⑦ (1) 61024-LT |
| ⑫ (N) FLOORING IN ALL VS DISPLAY WINDOWS INV #70964 STONE SOURCE | |
| ⑫ (N) FLOORING INV #70963 STONE SOURCE | |
| ⑫ (2) INV #59740 ARRAY | |
| ⑫ (1) INV #76039-LT | |

NON-SALES / ASSOCIATE AMENITY AREA BREAKDOWN

| | |
|-------------------------|---|
| 1 PERSON MANAGER OFFICE | |
| 2 PERSON MANAGER OFFICE | |
| 3 PERSON MANAGER OFFICE | X |
| BREAK AREA | |
| BREAK ROOM | X |
| MULTIUSE ROOM | |
| OPS OFFICE | |
| OPS/CASH OFFICE | |
| TRAINING ROOM | |
| DSM OFFICE | X |
| RSM OFFICE | |

REFER TO SHEET A00.3 FOR FINISH SCHEDULE

NOTE: HATCHED AREA INDICATES AREA NOT INCLUDED IN SCOPE. G.C. TO VERIFY ALL FIXTURES ARE IN GOOD WORKING CONDITION AND TOUCH UP FINISHES AS NECESSARY.

FIXTURE KEY: FIXTURES SHOWN WITH A SOLID LINE, CROSS HATCH, AND MARKED AS (E) ARE EXISTING. REFER TO PLAN FOR LOCATION AND COLOR.

FIXTURES SHOWN WITH A SOLID LINE, NO CROSS HATCH, AND MARKED AS (N) ARE NEW FIXTURES ADDED TO THE STORE IN THIS SCOPE.

PRESENTATION & FIXTURE PLAN KEYNOTES

Stantec
Stantec Architecture Inc.
1383 N. McDowell Blvd., Suite 250
Petaluma, CA 94954
Tel. 707.765.1660 Fax. 707.765.9908
www.stantec.com

Limited brands
LIMITED STORE PLANNING, INC.
d/b/a STORE DESIGN & CONSTRUCTION
Three Limited Parkway • Columbus, Ohio 43230
Telephone: 614.415.7000 • Fax: 614.415.7349

PROJECT INFORMATION: 010500485
VICTORIA'S SECRET
CAROLINA PLACE
11025 CAROLINA PLACE PKWY
SPACE B-11
PINEVILLE, NC 28134
SCOPE: DESIGN TYPE: REFRESH / PACKAGE: NMA / ANGELS / GENERATION: 00059286 / A/E PROJECT #: 2007684009

REVISIONS:

| NO. | DESCRIPTION | DATE |
|-----|--|------|
| 1 | ELITE CONSTRUCTION GROUP LAKE JACKSON, TX PHONE: 979-285-0712 NOTE: THESE PRINTS HAVE BEEN REDUCED BY 50 PERCENT SCALE WILL BE 50 PERCENT OF WHAT IS NOTED ON PLANS | |

DATE ISSUED: 9/26/14
DESIGNED BY: KW
DRAWN BY: CW
CHECKED BY: DB

PRESENTATION AND FIXTURE PLAN
DRAWING NUMBER: A06.2